

SPECIFICATION SERIES

PROJECT _____
 TYPE _____

6" RECESSED CFL LENS LIGHT

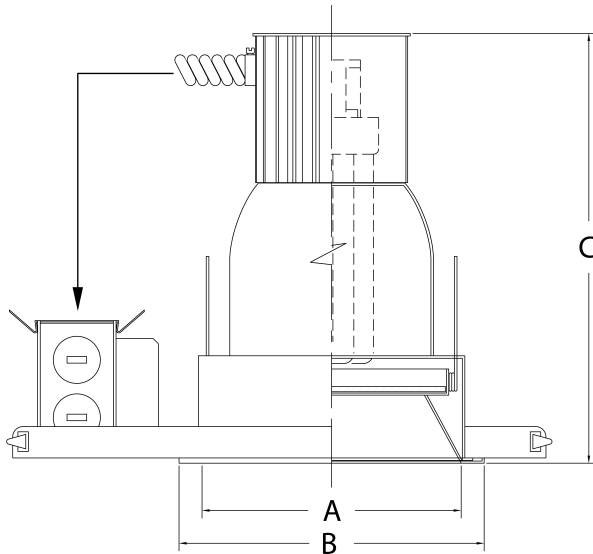

	A	B	C	LENGTH	WIDTH	CUT OUT
INCH	6.125	7.25	10.25	8.00	5.50	6.75
MM	155.58	184.15	260.35	203.20	139.70	171.45

FEATURES:

- LOW IRIDESCENT REFLECTOR
- HEAVY EXTRUDED ALUMINUM HEAT SINK
- GALVANIZED STEEL FRAME
- SUITABLE FOR THROUGH BRANCH CIRCUIT WIRING
- FACTORY PRE-WIRED FOR EASY INSTALLATION
- UL LISTED UNIVERSAL VOLTAGE ELECTRONIC BALLAST

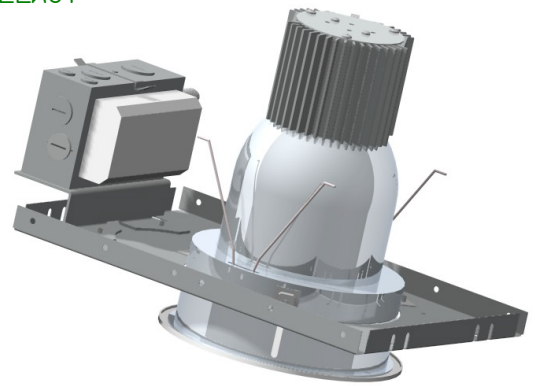

ORDER INFORMATION:

SERIES	LAMP	VOLTS	REFLECTOR	TRIM	COLOR	LENS	OPTION	OPTION	OPTION
SP-VFL6	1-18T	120/277	CL	CLW	MTL	CGL	DIMA	EM	CP
	1-26T		CWW	MWT	WHT	C73	DIMH	ETS	WET
	1-32T				BLK	FNL	F		
	1-42T				BRZ				

OPTIONS:

CL	CLEAR	FNL	FRESNEL LENS
CWW	CLEAR WALL WASH	DIMA	ADVANCE MK10 DIMMING
CLW	CLEAR WHITE TRIM	DIMH	LUTRON HILUME DIMMING
MWT	MATTE WHITE TRIM	EM	EMERGENCY BATTERY PACK
MTL	BRUSHED/POLISHED ALUMINUM DOOR	ETS	EMERGENCY TRANSFER DEVICE
WHT	WHITE POWDER COAT DOOR	SCA	SLOPE CEILING ADAPTOR*
BLK	BLACK POWDER COAT DOOR	F	FUSE
BRZ	BRONZE POWDER COAT DOOR	CP	CHICAGO PLENUM*
CGL	CLEAR GLASS LENS*	WET	UL WET LOCATION*
C73	CORNING PATTERN 73 LENS		

* PLEASE CONSULT FACTORY

LIGHT ONE, INC. P.O. BOX 389-PLAINFIELD, IL 60544 • TEL:773-7478100 • FAX:773-747-8778

WWW.LIGHTONEINC.COM