

Surface Mount

7.5" Surface Horizontal Compact / PL Cylinder

C-HF7.5

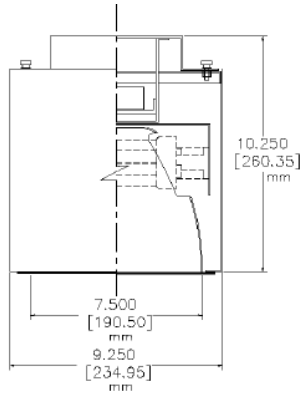

- Low iridescent ALZAK® reflector with polished self flange
- Heavy gauge spun aluminum housing
- Surface, wall and pendant mount available
- Standard colors: bronze, black and white
- Electronic ballast standard
- Factory pre wired
- UL 1598
- For UL wet location consult factory

Type	Cat. No.
_____	_____
Project:	_____
Notes:	_____

CONSULT FACTORY FOR PHOTOMETRIC REPORT

MOUNT	SERIES/SIZE	COLOR	LAMP	REFLECTOR	VOLT
C	HF 7.5	SPECIFY	1 OR 2 13Q	CL	120/277
C	HF 7.5	SPECIFY	1 OR 2 18Q	CL	120/277
C	HF 7.5	SPECIFY	1 OR 2 26Q	CL	120/277
C	HF 7.5	SPECIFY	1 32T	CL	120/277
C	HF 7.5	SPECIFY	1 57T	CL	120/277

options

- | | |
|--|---|
| <input type="checkbox"/> CG - CHAMPAGNE GOLD ALZAK® | <input type="checkbox"/> DIMH - LUTRON HILUME DIM BALLAST 18 TO 57 WATT |
| <input type="checkbox"/> PW - PEWTER ALZAK® | <input type="checkbox"/> DIMA - ADVANCE MK 10 DIM BALLAST 18 TO 57 WATT |
| <input type="checkbox"/> EM - EMERGENCY BATTERY PACK | <input type="checkbox"/> EM - EMERGENCY BATTERY PACK |
| <input type="checkbox"/> ETS - EMERGENCY TRANSFER DEVICE | <input type="checkbox"/> ETS - EMERGENCY TRANSFER DEVICE |
| <input type="checkbox"/> HAZE - ADD TO ANY ABOVE | <input type="checkbox"/> S - SURFACE MOUNT |
| <input type="checkbox"/> BMB - BLACK BAFFLE TRIM | <input type="checkbox"/> W - WALL MOUNT |
| <input type="checkbox"/> MWT - MATTE WHITE TRIM FLANGE | <input type="checkbox"/> WW - WALL WASH |
| <input type="checkbox"/> WET - UL WET CONSULT FACTORY | <input type="checkbox"/> P - PENDANT MOUNT 2FT HANG-STRAIGHT STD |
| <input type="checkbox"/> BRZ - BRONZE POWDER COAT | <input type="checkbox"/> CGL - CLEAR GLASS LENS CONSULT FACTORY |
| <input type="checkbox"/> BLK - BLACK POWDER COAT | <input type="checkbox"/> F - FUSE |
| <input type="checkbox"/> WHT - WHITE POWDER COAT | <input type="checkbox"/> RF - RETRO FIT CONVERSION KIT CONSULT FACTORY |

C-HF 7.5 - _____ - _____ - _____ - _____
 TYPE LAMP REFLECTOR VOLTAGE OPTIONS

7.5" SURFACE HORIZONTAL COMPACT / PL CYLINDER